

~~Castle Bolton~~

PLACE Castle Bolton, Yorkshire  
REEL MY-70 DATE May 7, 75  
RECORDER Nag @ 7.5 ips

WORLD SOUNDSCAPE PROJECT FIELD RECORDING SHEET

PLACE: Castle Bolton <sup>within lower courtyard</sup>

SUBJECT: WIND TIME: 5:30 ~~am~~ pm

MIC. DISTANCE: \_\_\_\_\_ ft.

INTENSITY: 56 dBA @ w ft. } ambient  
74 dBC @ m ft. }

REMARKS:

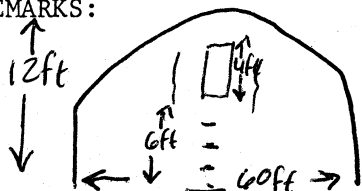

wind blowing within the courtyard. some foliage growing from the ruins nestles in the wind. The wind rumbles low and rushes in the midrange. Occasionally a sheep bleats, but this may not be on tape

POTS 90

PLACE: Castle Bolton <sup>another location in the lower courtyard</sup>

SUBJECT: WIND TIME: 5:45 ~~am~~ pm

MIC. DISTANCE: \_\_\_\_\_ ft.

INTENSITY: 55 dBA @ \_\_\_\_\_ ft. } amb.  
76 dBC @ \_\_\_\_\_ ft. }

REMARKS:

There is a high pitched sound in here as well as the rustle of foliage & the rushing wind.

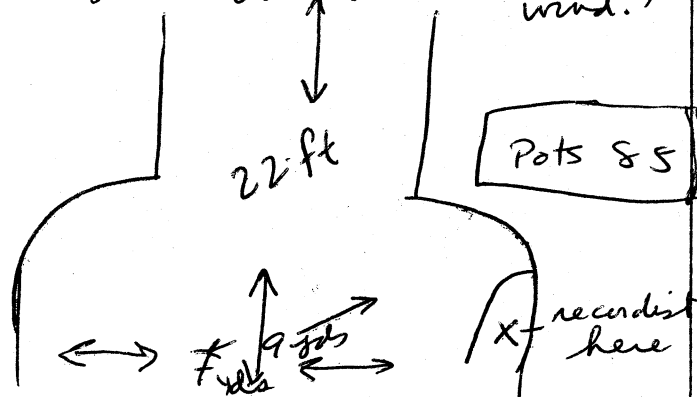

POTS 85

PLACE: Bainbridge

SUBJECT: ~~WIND~~ HORN TIME: 8:55 ~~am~~ pm

MIC. DISTANCE: 1 ft.

INTENSITY: \_\_\_\_\_ dBA @ \_\_\_\_\_ ft.  
\_\_\_\_\_ dBC @ \_\_\_\_\_ ft.

REMARKS:

Blown by Jack Metcalfe in the lobby of the Rose & Crown Hotel where Jack has been a patron for 57 yrs. preceded by reading of horn inscription.

on a clear night can hear bell from Askris (about 1 mile) can also hear fire siren from Hawes (old wartime side). wind like today called "a thin"

4) Baunbridge

Bruce + Jack Metcalfe talk while walking to blowing sight.

Ambience 38-40 dBA  
48-52 dBC

POTS 90

5)

Baunbridge  
Winter Horn from in front of J. Metcalfe's House  
mic distance 41 meters

70-76 dBA @ 41 meters

Wind at 15 mph out of the east

POTS 90

4 sets of three blows each

also includes bells from Midland Bank  
~~about~~ 44-48 dBA @ 41 meters  
recorded at 28 meters  
(Building formerly a church dates 187

2 cars pass during third + fourth sets.

More conversation about the Winter horn walking back to pub

POTS 90

9.05 pm

PLACE Castle Bolton, Yorkshire  
REEL NY-7 ② DATE May 7, 75  
RECORDER Nag @ 7.5 ips

WORLD SOUNDSCAPE PROJECT FIELD RECORDING SHEET

PLACE: St. Oswald's church  
SUBJECT: door and  
ambience TIME: 6:00 am (pm)  
MIC. DISTANCE: \_\_\_\_\_ ft.  
INTENSITY: 35 dBA @ \_\_\_\_\_ ft.  
58 dBC @ \_\_\_\_\_ ft. } amb  
REMARKS:

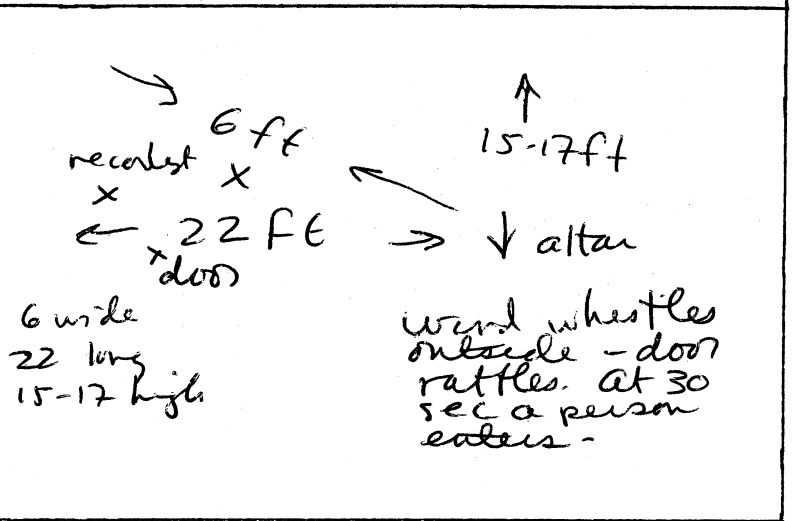

PLACE: St Oswald's  
SUBJECT: barney  
door TIME: \_\_\_\_\_ am/pm  
MIC. DISTANCE: \_\_\_\_\_ ft.  
INTENSITY: \_\_\_\_\_ dBA @ \_\_\_\_\_ ft.  
\_\_\_\_\_ dBC @ \_\_\_\_\_ ft.  
REMARKS:  
close up of door as it  
is blown by wind in  
closed position

a person enters

PLACE: St. Oswald's  
SUBJECT: person church  
leaving TIME: \_\_\_\_\_ am/pm  
MIC. DISTANCE: \_\_\_\_\_ ft.  
INTENSITY: \_\_\_\_\_ dBA @ \_\_\_\_\_ ft.  
\_\_\_\_\_ dBC @ \_\_\_\_\_ ft.  
REMARKS:

\_\_\_\_\_

4) Banbridge

Winter Horn 8:55pm  
 Blown by Jack Metcalfe in  
 the lobby of the Rose + Crown  
 Hotel where Jack has been a  
 patron of the pub for 57 yrs.  
 Preceded by reading of horn  
 inscription

not on tape: on a clear night  
 can hear bells from  
 Askric (1 mile away)  
 - can hear fire seen from Hawes  
 (old wartime seen)  
 - word of the kind today called  
 "a thin"  
 POTS 90

5) Banbridge -  
 Jack + Bruce talk while  
 walking to blowing sight.  
 Abience 38-40A  
 48-52C

POTS 90

6) Banbridge  
 Blowing of the Winter horn from  
 in front of J. Metcalfe's house  
 mic distance 41 meters  
 70-76DbA @ 41 meters  
 Wind from the East @ 15mph

4 sets of three blows each \*  
 also includes <sup>clock</sup> bells from atop an ~~unmarked~~ <sup>unmarked</sup> ~~church~~ <sup>church</sup>  
~~at 199m~~ ~~Bank~~ ~~from the bank~~  
~~at 199m~~ ~~Bank~~ ~~from the bank~~  
~~at 199m~~ ~~Bank~~ ~~from the bank~~  
 distance = 62 meters (at 50m)  
 23/39 44-48DbA @ 50 meters  
 \* one car passes during 3rd set  
 another car passes during 4th set.

POTS 90

7) Mae conversation about the winter  
 the pub.

horn while walking back to

POTS 90

Jack began blowing in 1947

PLACE Barnbridge  
REEL Mya DATE \_\_\_\_\_  
RECORDER \_\_\_\_\_ @ \_\_\_\_\_ ips

RLD SOUNDSCAPE PROJECT FIELD RECORDING SHEET

PLACE: Village green  
SUBJECT: First Horn TIME: 3:15 am/pm  
MIC. DISTANCE: 20 ft.  
INTENSITY: \_\_\_\_\_ dBA @ \_\_\_\_\_ ft.  
                  \_\_\_\_\_ dBC @ \_\_\_\_\_ ft.

REMARKS: The original horn, blown by Jack Metcalfe, from  
front outside bin house by the Village green.  
horn 17-70A @ 20m. (42 dBA minimum) Several sets of  
3 blasts each - last one is best. pots 83

PLACE: \_\_\_\_\_  
SUBJECT: \_\_\_\_\_ TIME: \_\_\_\_\_ am/pm  
MIC. DISTANCE: \_\_\_\_\_ ft.  
INTENSITY: \_\_\_\_\_ dBA @ \_\_\_\_\_ ft.  
                  \_\_\_\_\_ dBC @ \_\_\_\_\_ ft.

REMARKS:

PLACE: \_\_\_\_\_  
SUBJECT: \_\_\_\_\_ TIME: \_\_\_\_\_ am/pm  
MIC. DISTANCE: \_\_\_\_\_ ft.  
INTENSITY: \_\_\_\_\_ dBA @ \_\_\_\_\_ ft.  
                  \_\_\_\_\_ dBC @ \_\_\_\_\_ ft.

REMARKS:
