



2017 Surveyor Package for Boundary Bay 92

Thank you again for agreeing to survey Boundary Bay 92. Your survey times are listed below. A few days before the survey, read the methodology, and check the map, to identify your survey point and the area to be surveyed. For each survey date, you will require one copy of each of the map sheet, and each of the datasheets. If you are performing independent counts in a group, make sure each team member has a copy of the data and map sheets. If you have any questions, email me at dhope@sfu.ca.

	July				August			
	21	22	23	24	18	19	20	21
Start	02:30 PM	02:30 PM	03:15 PM	04:00 PM	01:30 PM	02:00 PM	02:30 PM	03:00 PM
End	05:00 PM	05:00 PM	05:45 PM	06:30 PM	04:00 PM	04:30 PM	05:00 PM	05:30 PM



Boundary Bay 92 Maps

Date: _____

Tide Locations

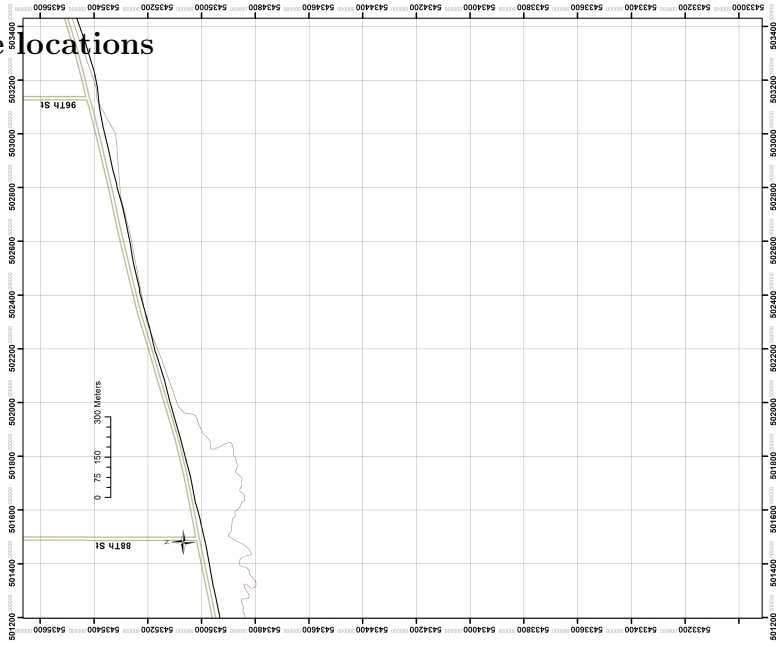

WESA Location

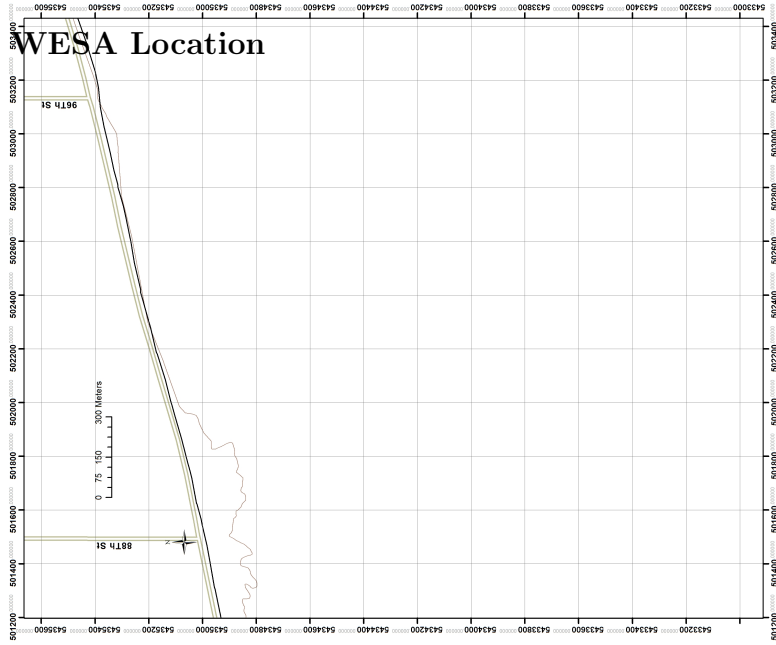

Falcon Observations

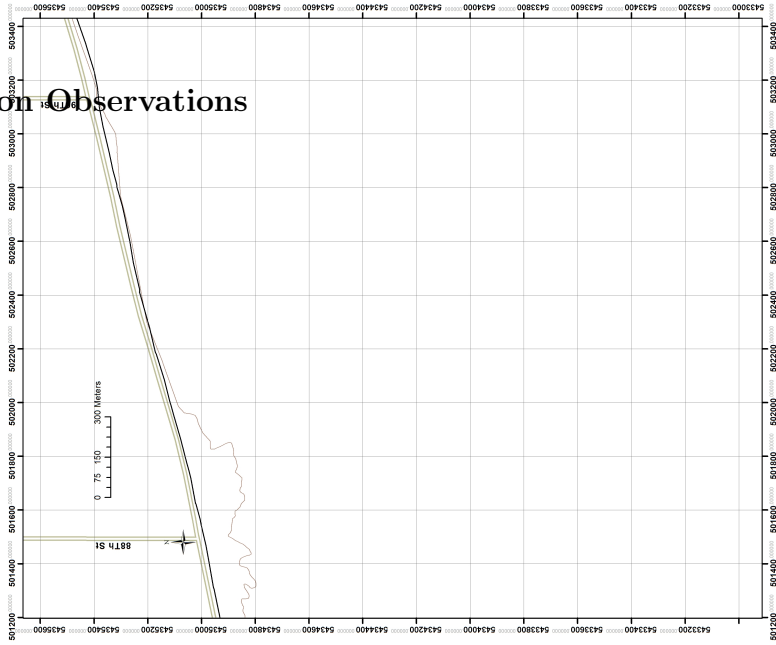

Other: _____

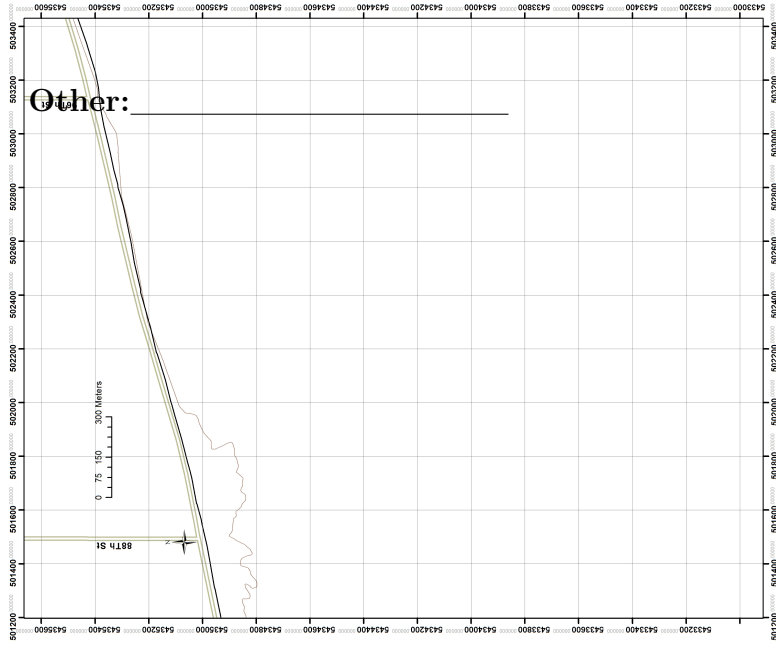



BIRD STUDIES
ÉTUDES D'OISEAUX CANADA

Summer Shorebird Pulse Datasheets



OBSERVER Name: _____	ADDITIONAL OBSERVER Name: _____
Address: _____ email: _____ Tel: _____	
SURVEY SITE Name: _____	If you survey as a team: <input type="checkbox"/> Independent counts <input type="checkbox"/> Collaborative
Date: _____ Start Time: _____	
End Time: _____	
Ratio of WESA to LESA (numbers with total counted): _____	

SURVEY CONDITIONS (please circle the appropriate description)						
Weather	Clear	Partly-Cloudy	Overcast	Fog		
Precipitation	Rain	Snow	Rain & Snow	None		
Sea State	Calm	Rippled	Choppy	Wavy	Rough	
Tide State Start	High-tide	Mid-high	Mid-tide	Mid-low	Low-tide	
Tide State End	High-tide	Mid-high	Mid-tide	Mid-low	Low-tide	
Visibility	How far do you have V.GOOD visibility?	<100	100m	250m	500m	1km
If visibility was poor, what was the reason? Glare Sea-conditions Weather Other: _____						

Survey Equipment:	Binoculars	Spotting Scope	Both
-------------------	------------	----------------	------

Human Activity	Please give approx. numbers of shoreline users observed during survey or check "No Activity"
<input type="checkbox"/> No Activity	Walkers: _____ Dogs: _____ Powered Boats: _____ Unpowered Boats: _____ Other (specify): _____

Photo File Names: _____

COMMENTS & ADDITIONAL INFORMATION

SAFETY: Coasts can be dangerous places. Please take great care. Please inform someone of when you are surveying and your expected return time. Please wear appropriate clothing for the weather. Bird Studies Canada cannot accept responsibility or liability for accidents during the Shorebird Pulse Survey. **THANK YOU FOR YOUR HELP AND PARTICIPATION!**

WESA Count Form

Site: _____ Date: _____

Please mark on the map the area surveyed and if possible the tide line. Note the survey area with an 'S' and the tide with the time. If you are breaking the area down into multiple survey areas, please note this on the map and in the notes section. You only need to mark the survey area on your first map. See the methodology for instructions on marking falcons and Western Sandpipers on the map.

Key: Method: Direct Count (DC) Estimation (Est)
 Flock Density: 1) Spread-out 2) Medium dense 3) Dense 4) Medium-Thick 5) Thick
 Tide Distance: Estimate of average distance of tide line to shore (meters)

Time	Total Count	WESA or Peeps	Method?	Flock Density	Tide Distance
Example 15:00	150	Peeps	DC	3	200

Notes and Calculations (Please use this area to make notes to assist with estimation):

